



### Tree Planting Schedule

Name	Qty	Root	Girth
Betula jacquemontii	2	Ø3	18-20cm
Prunus calleryana 'Chanticleer'	4	Ø3	18-20cm
	6		

### Planting Schedule

Herbaceous			
Name	Qty	Pot Size	Grade
Agastache Foeniculum	28	5L	50-40cm
Aster 'Monch'	28	5L	50-40cm
Salvia nemerosa	28	5L	50-40cm
	84		
Shrub			
Name	Qty	Pot Size	Grade
Brachyglottis 'Sunshine'	14	10L	40-60cm
Cornus sarcomia 'Midwinter Fire'	14	10L	60-80cm
Choisya ternata 'Sundance'	4	10L	40-60cm
Choisya ternata 'White Pizzler'	20	10L	40-60cm
Eunymus fort. 'Emerald in Gold'	57	5L	50-40cm
Eunymus fort. 'Silver Queen'	19	10L	40-60cm
Hebe franciscana 'Variegata'	2	10L	50-40cm
Hebe pinnatifida 'Sutherlandii'	5	10L	40-60cm
Hebe rakameia	16	5L	50-40cm
Lavandula ang. 'Munstead'	7	10L	40-60cm
Nandina domestica 'Firepower'	19	10L	40-60cm
Osmarthus heter. 'Variegata'	4	10L	40-60cm
Pitoporum tenuifolium 'Golf Ball'	8	10L	50-40cm
Phloxium 'Jester'	2	10L	80-100cm
Prunus laetifica	207	15L	100-125cm
Prunus l. 'Otto Luyken'	20	5L	40-60cm
Protea fraseri 'Red Robin'	18	10L	60-80cm
Pitoporum tenuifolium 'Tom Thumb'	6	10L	50-40cm
Phloxium 'Yellow Wave'	8	10L	60-80cm
	454		
	558		

Sample Images of Landscaping:

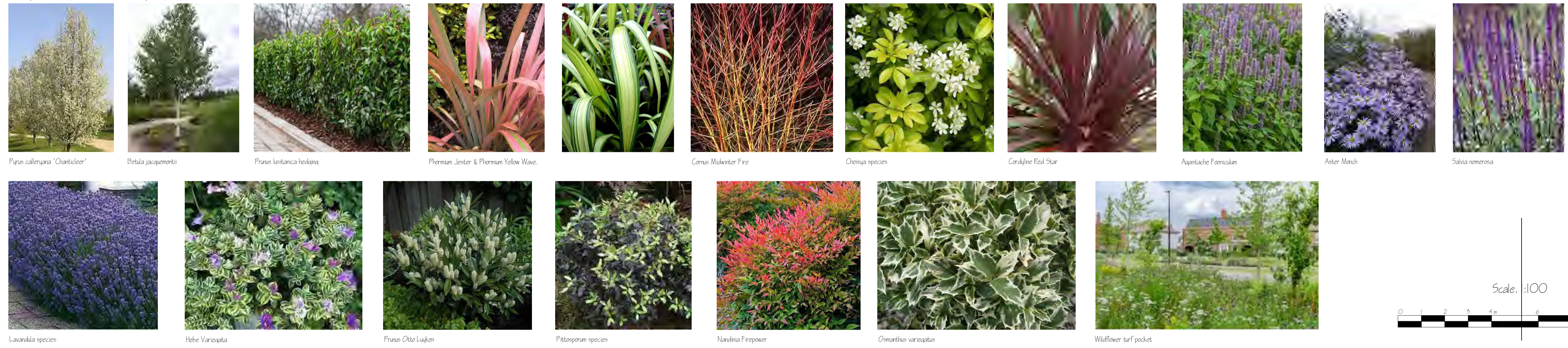

C	Plants updated to latest site layout. Amendments to planting for wet parts. Existing trees moved to their position.	22.09.24
D	20% additional items to planting.	19.09.24
A	Minor changes to planting option and addition of willflower turf.	28.07.24

**MBM Landscapes Ltd.**

date: Jan 2025 project: Leshin Sea  
 scale: 1:100 as A drawing by: MBM  
 drawing no: 101 drawing: Landscape Proposals  
 rev: C

