



PROPOSED FRONT ELEVATION



PROPOSED SIDE ELEVATION
ALL SIDE GLAZING TO BE OBSCURE GLASS



PROPOSED REAR ELEVATION



PROPOSED SIDE ELEVATION
ALL SIDE GLAZING TO BE OBSCURE GLASS

PROPOSED ELEVATIONS - 1:100

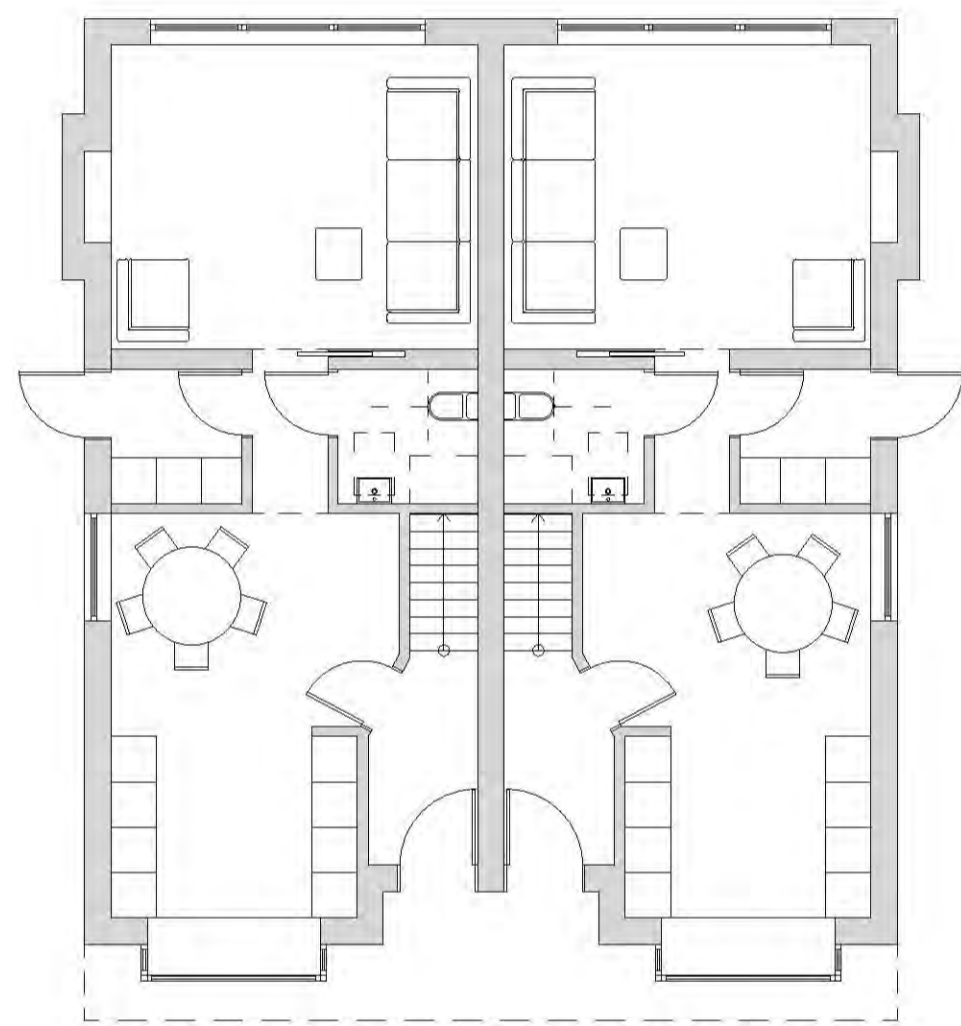

PROPOSED GROUND FLOOR PLAN

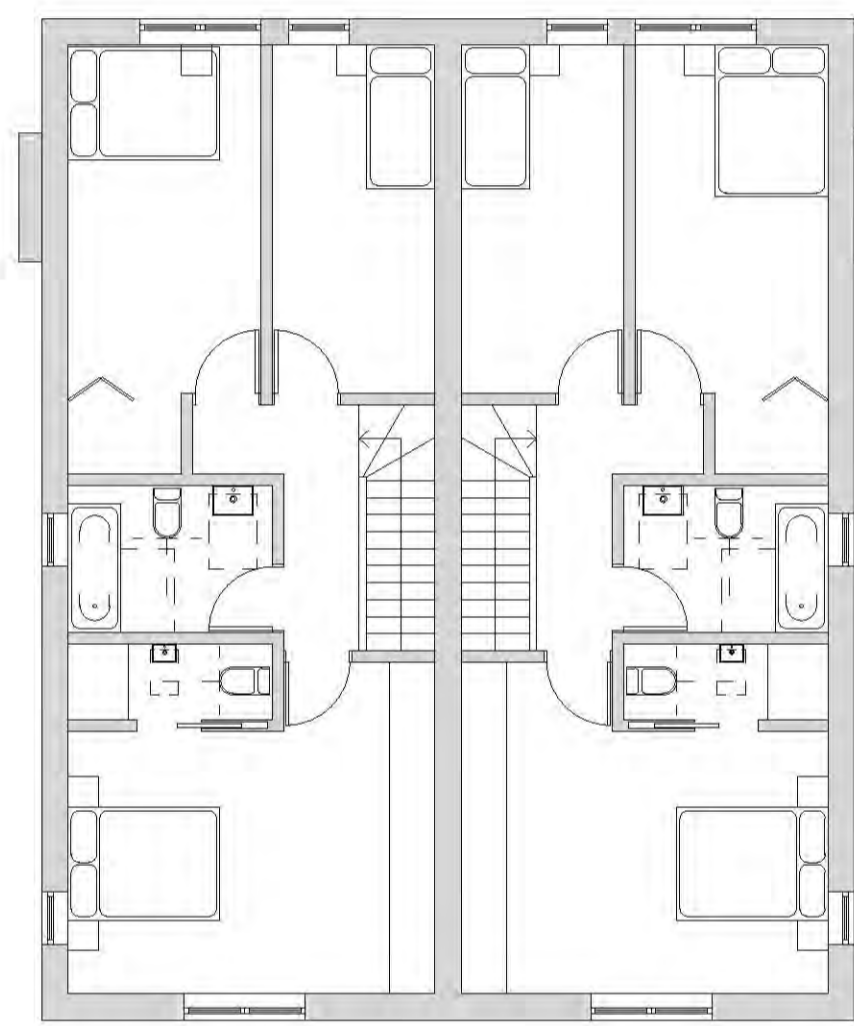

PROPOSED FIRST FLOOR PLAN

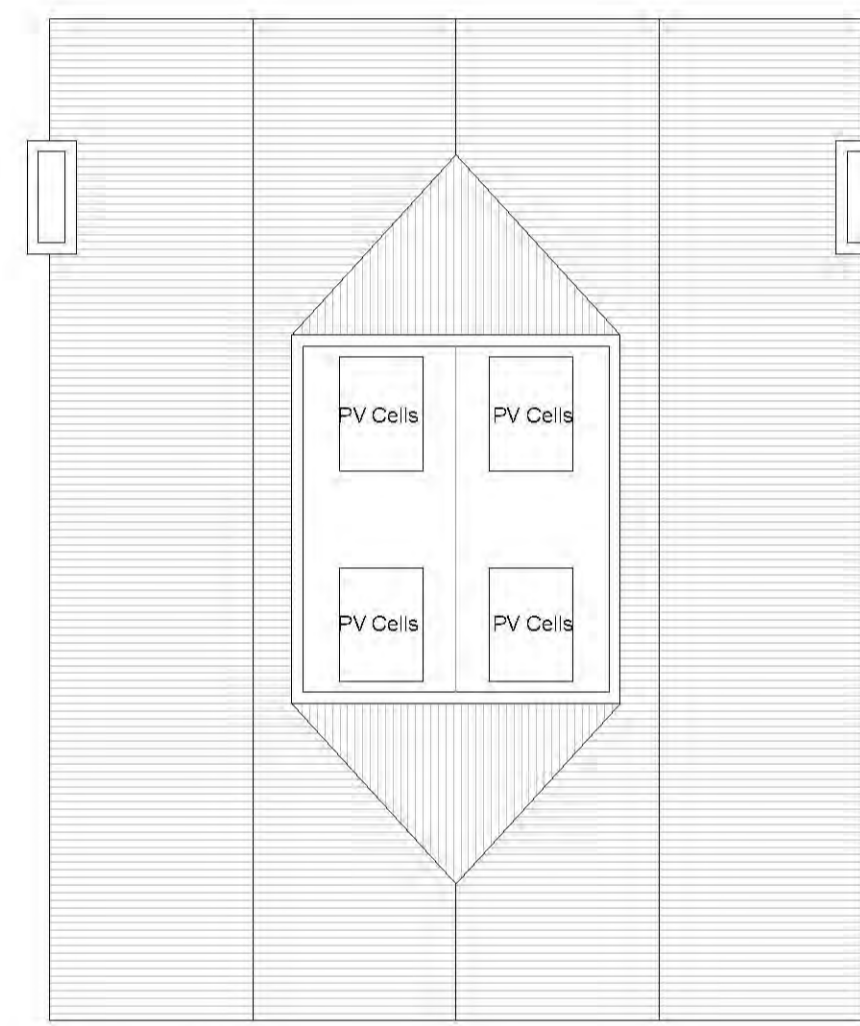

PROPOSED ROOF PLAN

PROPOSED PLANS - 1:100

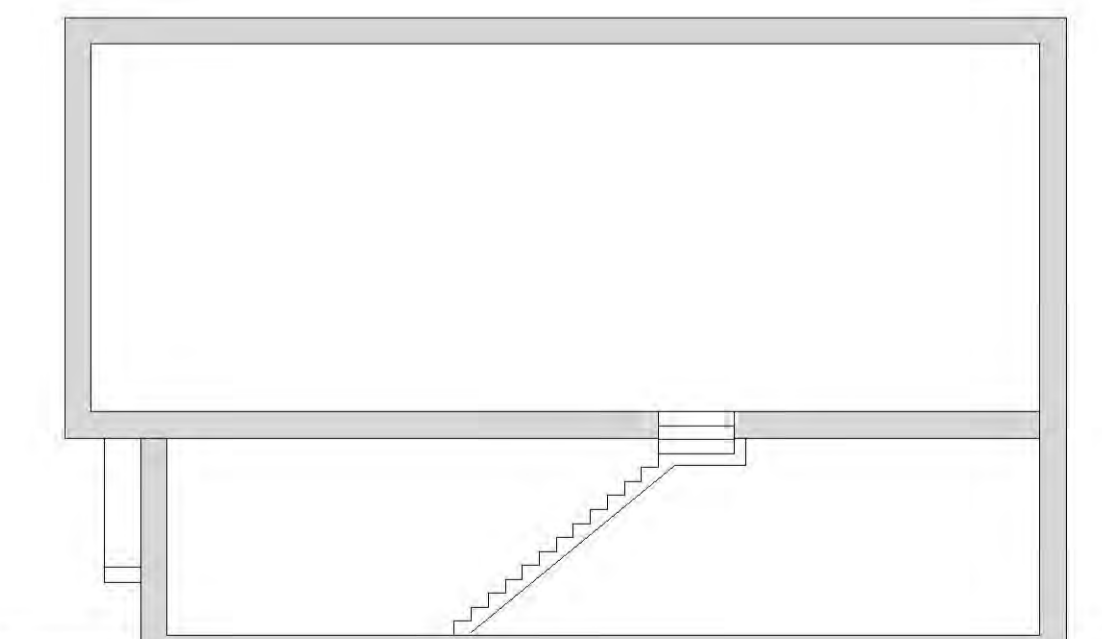

PROPOSED SECTION - 1:100

| | |
|-------|--|
| Notes | |
| | |

| Rev | Comment | By | Date |
|-----|---------|----|------|
| | | | |

Stage:
3 - Developed Design

Client:
Mr G Newton

Project:
Hayden House
10 Underwood Square
Leigh - on - sea
SS0 8PB

Drawing Title:
Proposed - Northern Plot

| | | | |
|-------------|------------|-----------|---------|
| Drawing no: | 385-P102 | Revision: | |
| Project no: | 385 | Drawn by: | DS, MRS |
| Scale: | 1:100 @ A1 | Chk by: | SK |

SKARCHITECTS
333-355 London Road
Westcliff-on-Sea
SS0 9SZ
Tel: 01702 559250
Email: info@skarchitects.co.uk

Do not copy from this drawing.
Drawing to be used in conjunction with all other issued drawings, documents and
relevant consultants' information.
An acknowledgment that this drawing is for guidance purposes only. All alterations must
be authorised.
This information is subject to Building Control requirements and other requirements
of all relevant statutory authorities and other service providers.
© SKARCHITECTS 10/2014