

EXISTING SHOPFRONT 1:50

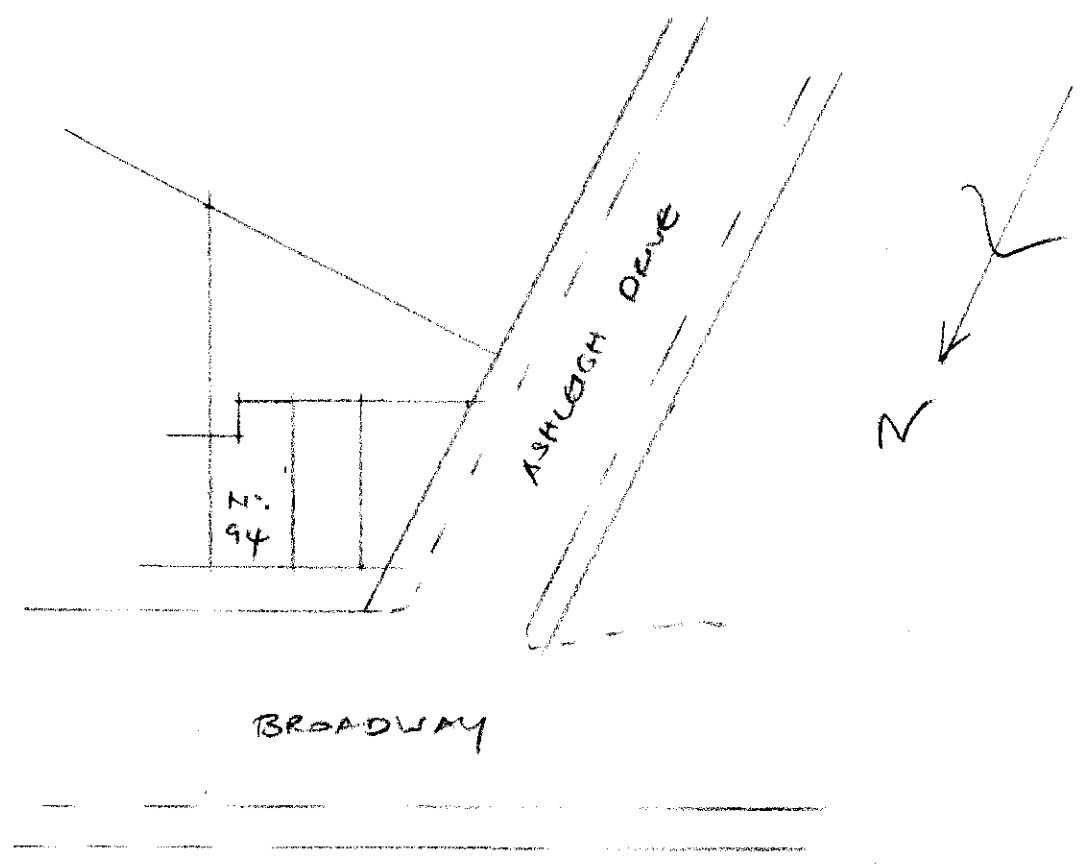

BLOCK PLAN 1:500

This drawing is copyright and shall not be reproduced or used for any other purpose without written permission of Trudys Architectural Consultants. Do not copy from this drawing, use figured dimensions only.  
 The drawing must be read in conjunction with all other related drawings and documentation in Trudys Architectural Consultants Terms and Conditions. Contractors are to check all sizes, levels and dimensions before setting out any site work, any errors or discrepancies to be reported immediately to Trudys Architectural Consultants.  
 It is the contractors responsibility to check all sizes, levels and dimensions on site prior to commencement, any errors or discrepancies to be reported immediately to Trudys Architectural Consultants.  
 All lines on contract are assumed and are to be checked prior to commencement by contractor / client.  
 Load bearing walls, floor joists, ceiling joists, boundary lines, external drainage are assumed and are to be checked prior to commencement by contractor / client.  
 Details and sizes shown are indicative only and are subject to confirmation by the relevant Specialist Sub-contractor.  
 It is the contractor's responsibility to ensure compliance with building regulations.  
 Foundation design is based on assumed soil conditions and subject to assessment upon excavation.  
 This drawing services only the purpose for which it is produced.  
 All heights, levels etc to suit existing.  
 Party Wall Act 1996 - the client is advised to seek advice.  
 Please note any work carried out before planning / lawful development / building regulation approval is at the clients / contractors own risk.  
 From 1<sup>st</sup> October 2015 CDM Regulations 2015 must be adhered to for all construction work.  
 Local Authority Community Infrastructure Levy Regulations 2010 may apply.

EXISTING SHOPFRONT :-

No 94, BROADWAY, LEIGH-ON-SEA for 'GOLDSMITHS'

DRAWING NO. 14/22/B