

SAFETY, HEALTH AND ENVIRONMENTAL INFORMATION

In addition to the hazards/risks normally associated with the types of work detailed on this drawing, note the following significant residual risks:

| | |
|-------------------------------|---|
| Construction | Existing Undertakers. The positions of Existing Undertakers assets and services have been based on information obtained from records and confirmed by ground penetrating radar. All must be regarded as approximate until confirmed by excavation. See Special Requirements section in Appendix 1/16. |
| Maintenance / Cleaning | NONE |
| Use | NONE |
| Decommissioning / Demolishing | NONE |

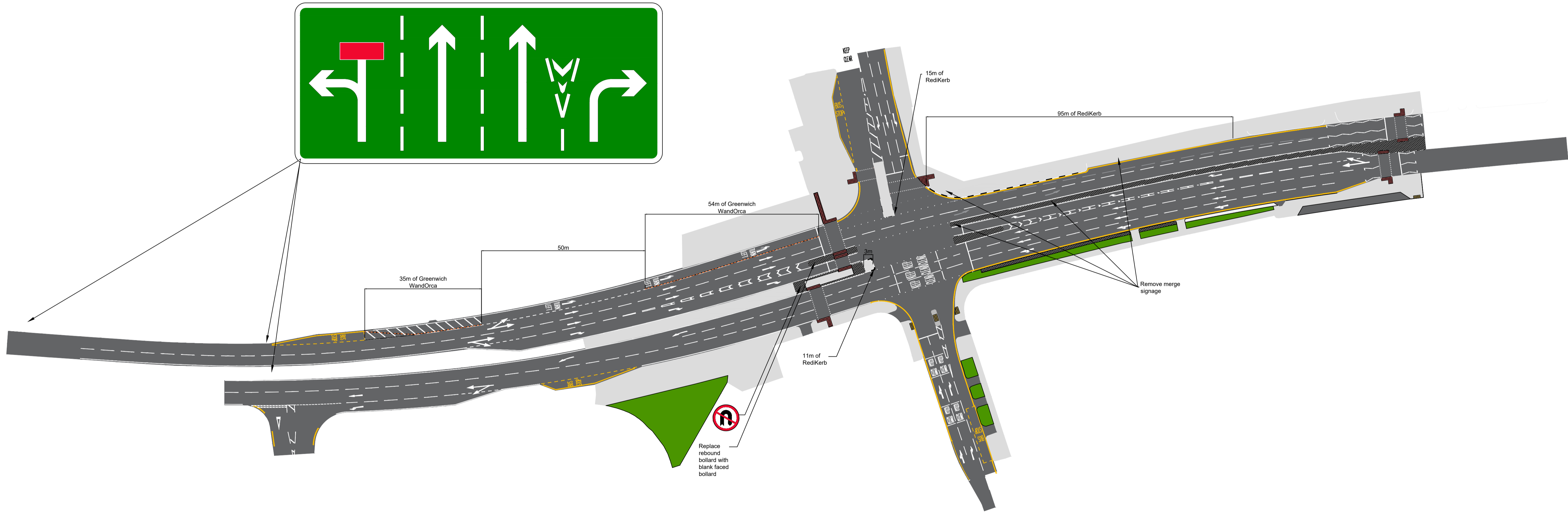

Replace rebound bollard with blank faced bollard

| | | | | |
|-----|----------------|-----|-----|------------|
| Rev | Description | Drn | App | Date |
| A | Original Issue | JC | NH | 18/12/2023 |

Southend-on-Sea
City Council
Neighbourhoods and Environment
PO Box 5560, Civic Centre
Victoria Avenue, Southend on Sea, SS2 6ZQ

Project Title
**A127 Kent Elms
Junction Re-Design**

Drawing Title
**General Arrangement
Sheet 1 of 1**

| | | | |
|---------|------------|----------|------------|
| Drawn | Date | Review | Date |
| JC | 18/10/2023 | ETB | 01/11/2023 |
| Checked | Date | Approved | Date |
| JM | 22/11/2023 | NH | 19/12/2023 |

Scales @ A0: 1:250
Revision: 0

Drawing Status: Detailed Design
Drawing Number: Kent Elms Merge Removal GA

This map is reproduced from Ordnance Survey material with the permission of Ordnance Survey on behalf of the Controller of the Queen's Stationery Office. Crown copyright. Unauthorised reproduction infringes Crown copyright and may lead to prosecution or civil proceedings. © 100019600